

### STLZ 990

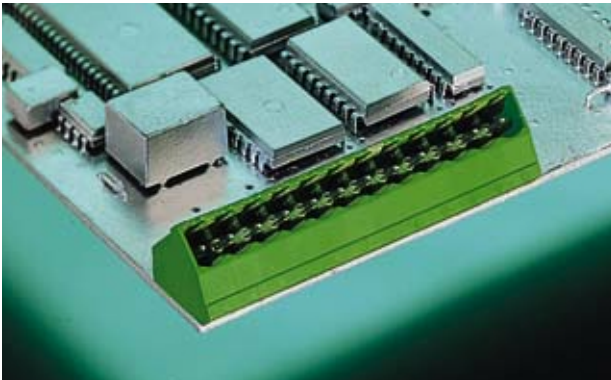

**STLZ 990/.. G - 5,08 - green**

**2-24 poles, Spacing 5,08 mm  
insert required no. of poles ..**

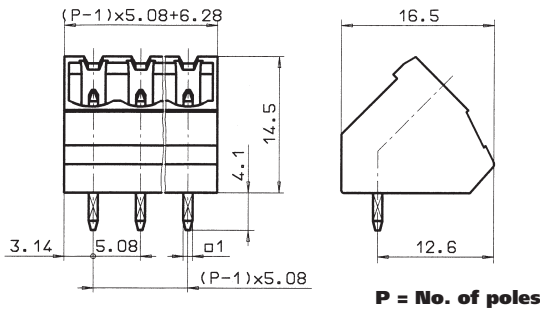

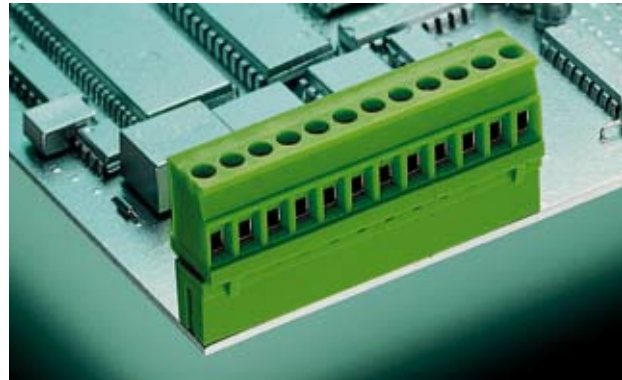
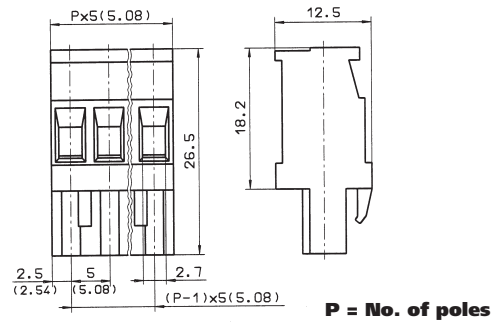
### AK(Z) 1100





**AK(Z) 1100/.. - 5,0 (5,08) - green**

**2-20 (16) poles, Spacing 5,0 mm or 5,08 mm  
insert required no. of poles ..**

#### Ratings:

			
	UL 1059	CSA 22.2 No. 158	DIN VDE 0627
Rated Voltage	300 V	300 V	250 V
Rated Current	15 A	15 A	12 A (T60)
Rating Impulse Voltage/Dirt Level			4 kV/3

#### Ratings:

	(BU02) 	(BU02) 	(BU02) 
	UL 1059	CSA 22.2 No. 158	DIN VDE 0627
Rated Voltage	300 V	300 V	250 V
Rated Current	15 A	12 A	12 A (T60)
Wire Size	AWG 22-10	AWG 22-10	2,5 mm <sup>2</sup>
Rating Impulse Voltage/Dirt Level			4 kV/3
Rated Torque / Screw Size			0,5 Nm/M3
<b>Max. Rated Cross Section</b>			
Single Wire (solid)			2,5 mm <sup>2</sup>
Stranded Wire (flexible)			2,5 mm <sup>2</sup>
Stranded wire with Ferrules			2,5 mm <sup>2</sup>

#### Dimensions

Spacing	5,0 mm
PCB Hole Diameter	1,4 mm

#### Materials

Insulating Material	PA
Flammability Class	UL94 V-0
Temperature Range	-30°C/+105°C
Contact Pin	Cu

Colour  
green

RAL 6018

#### Dimensions

Spacing	5,0 mm (5,08 mm)
Stripped Length	7,0 mm

#### Materials

Insulating Material	PA
Flammability Class	UL94 V-0
Temperature Range	-30°C/+105°C
Terminal Block	CuZn
Contact	CuSn

Colour  
green

RAL 6018